

*This Drawing Is Owned by J&V Electronic Science and Technology Co., Ltd., and the Use or Reproduction of All or Part of the Drawing Must Be Approved in Writing by J&V Electronic Science and Technology Co., Ltd.
此圖紙為劍威電子科技有限公司所擁有，所有或部份圖紙使用或复制必須經劍威電子科技有限公司書面同意。

版次 Version		物料 编号 Drawing No	
客户代号 Customers		客户料号 Customers No	

放大示意图

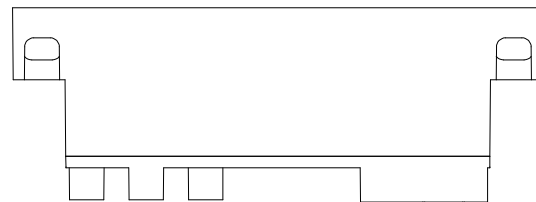
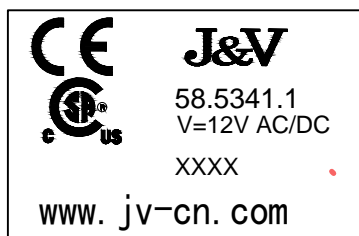

Technical Parameters:

1. Working Voltage: 12V AC/DC
2. Output Voltage: > 12KV
3. Working Current: < 120mA
4. Discharge Frequency: > 5Hz
5. High Voltage Output Terminal: 4 (2.8 * 0.5)
6. Discharge Distance: 4.0 - 5.5mm;
(Ignition wire length ≤ 1.8m)
7. Working Environment Temperature: -20°C - 105°C
8. Working Environment Humidity: < 95%
9. Working Life: > 35,000 times

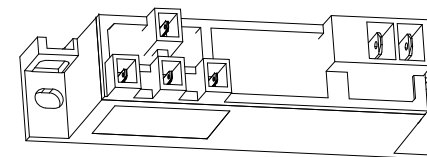
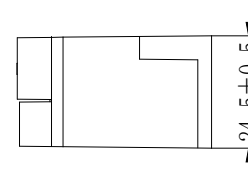
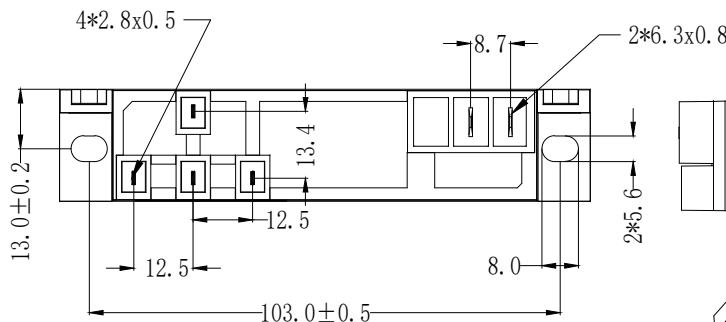
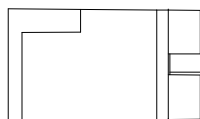
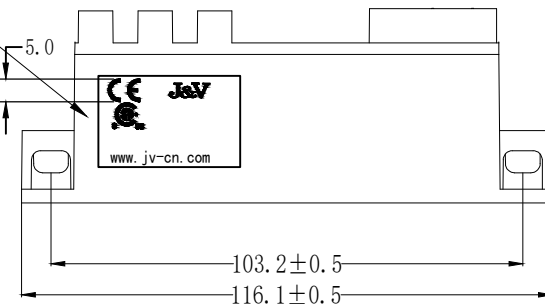

Materials:

1. Shell: PA66 flame-retardant, 150° C, black
2. Black adhesive: Epoxy resin
3. Terminal: Brass (tin-plated)

				产品 型号 Model No		图纸 编号 Drawing No	数量 Quantity	材 质 Material		
标记 Mark	更改前 Before Change	更改后 After Change	签名 Signature	制图/日期 Drawing/Date	刘凯 2021.12.03	规格 Specifications	12V	零件 名称 Parts Name	点火器	表面 处理 Surface Transaction
尺寸普通公差 Dimension Tolerance		±1	投影 方向 Projection Direction	校对/日期 Collation/Date		J&V Science & Technology Co., Ltd 劍威科技				
			角度 公差 Angle Tolerance	审核/日期 Verifyng/Date						

A B C D E F